

# **SEAVIEW**

**ELEVATE YOUR ELECTRONICS**

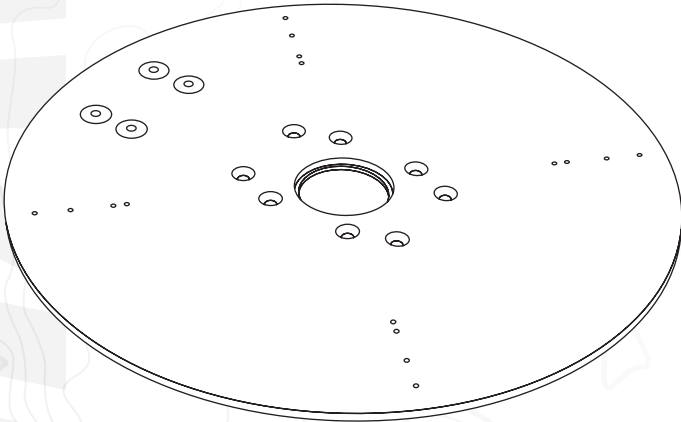

## **INSTALLATION INSTRUCTIONS**

For Seaview Modular Top Plate:

**ADA-S2**

Refer to website for most up to  
date instructions and videos.

**[WWW.SEAVIEWGLOBAL.COM](http://WWW.SEAVIEWGLOBAL.COM)**

# PARTS INCLUDED

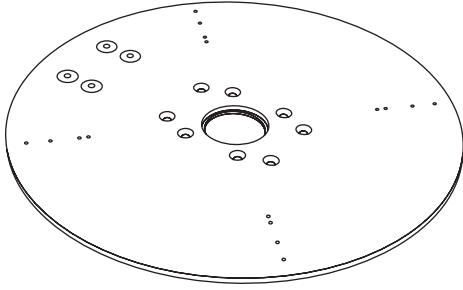

**X1**

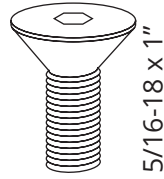

**X8**

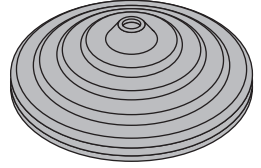

**X1**



# TOOLS NEEDED

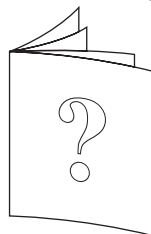
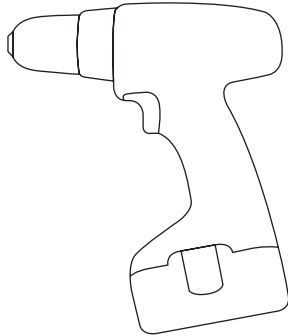
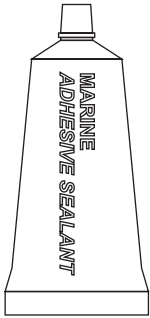

**1** Locate the Make and Model of your satellite dome on this chart and determine which drill hole number yours is. Then place the ADA-S2 Drill Template ontop of the ADA-S2.

1	<b>Intellian</b>	i6, i6P, k6, d6, S6HD, FB500
1	<b>KVH</b>	M7, M7SK, HD7, V7, TV6, FB500(26"), V3-IP(24")
2	<b>VDO</b>	Ocean Line 345, 360, 445 ,460
3	<b>Intellian</b>	i4, i4P, k4, d4, i5
3	<b>KVH</b>	M5, TRAC 50, TV5, FB250(18"), V7IP, VHTS
3	<b>Raymarine</b>	45STV
3	<b>SEA-TEL (COBHAM)</b>	ST14, FX150, C18, FX250
4	<b>KVH</b>	TracPhone V7-IP

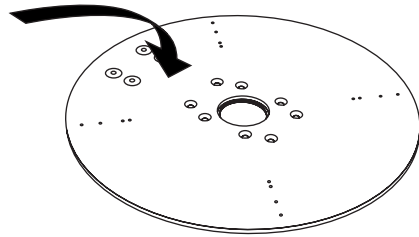
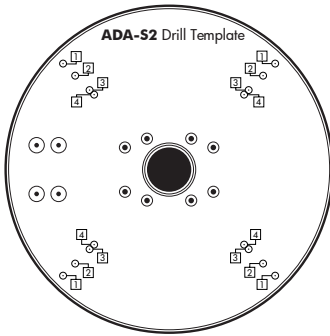

**2** Once you determine which drill hole number you require mark the four holes.

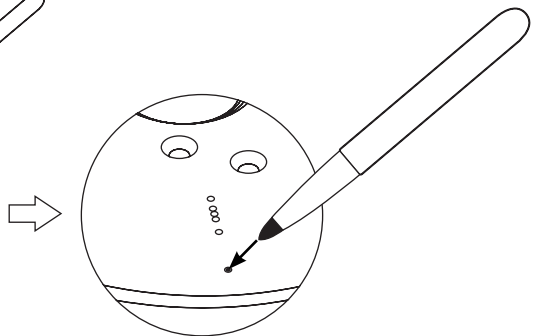
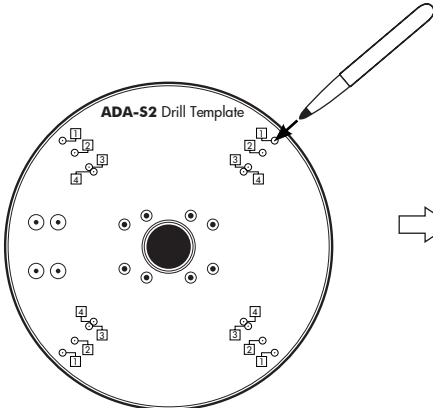

# 3

Drill the four marked holes. Be sure to check with your marine electronic manufacturers manual to determine what size drill bit is needed.

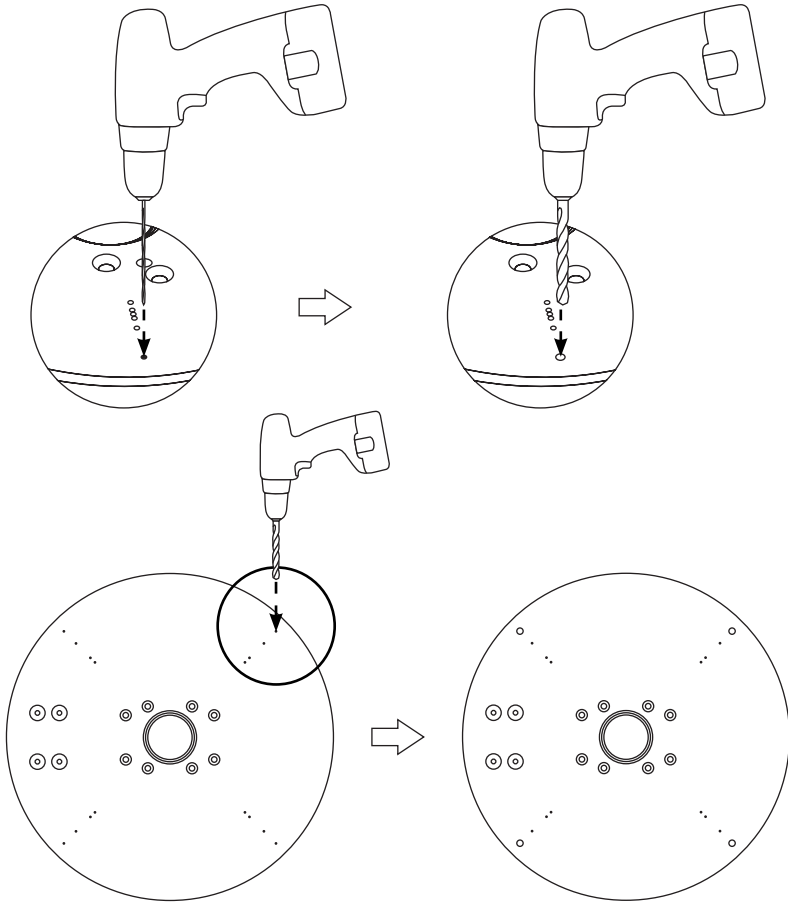

# 4

Apply marine adhesive sealant along the lip in the center hole on the ADA-S2. Route the cabling through the center hole in the ADA-S2. Then insert through the black rubber grommet. When inserting the black rubber grommet into the ADA-S2 be sure that the center lip falls into the groove in the grommet.

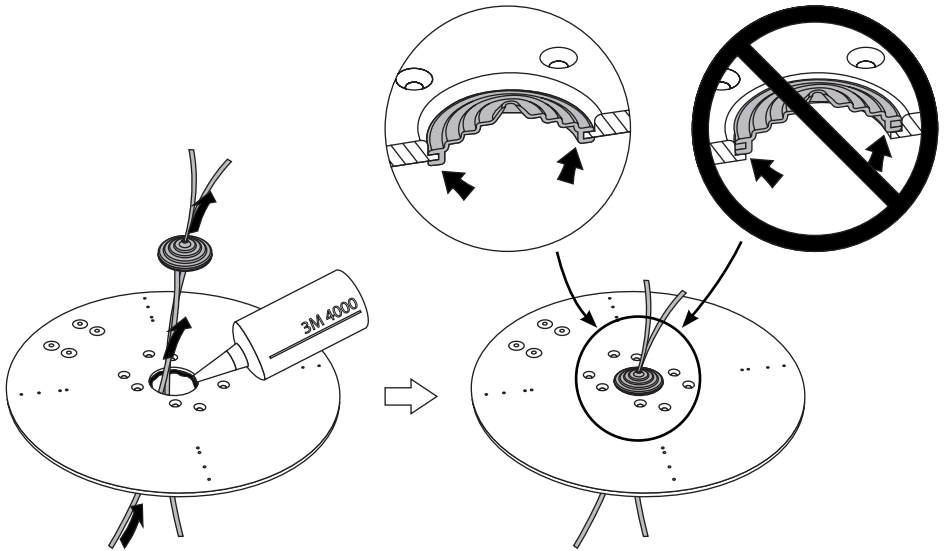

# ADA-S2

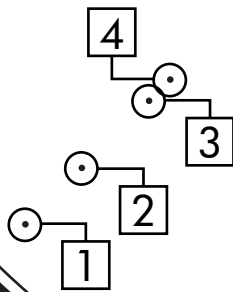
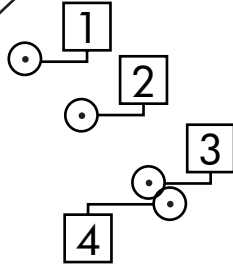

**NOT to scale**

# Drill Template

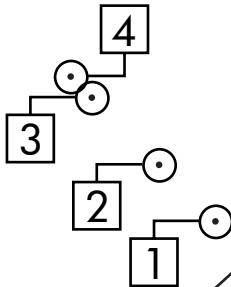
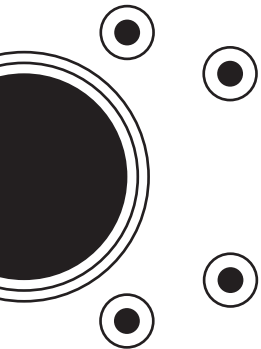
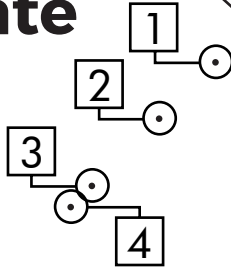

The background of the entire page is a light gray topographic map with white contour lines. The lines are irregular and wavy, representing terrain elevation. The map covers the entire page, with the text elements overlaid on it.

***SEAVIEW***///  
***ELEVATE YOUR ELECTRONICS***

***SEAVIEW***///

Tel: 800-655-7922  
[www.seaviewglobal.com](http://www.seaviewglobal.com)

***EUROPEAN OFFICE***

Tel: +33 4 94 53 27 70  
[www.seaviewprogress.com](http://www.seaviewprogress.com)

3-062618